

NKBA'S
PUGET
SOUND

KITCHEN & BATH

A PMG MAGAZINE

18 Winning
Designs
The **BEST** Kitchens and Baths

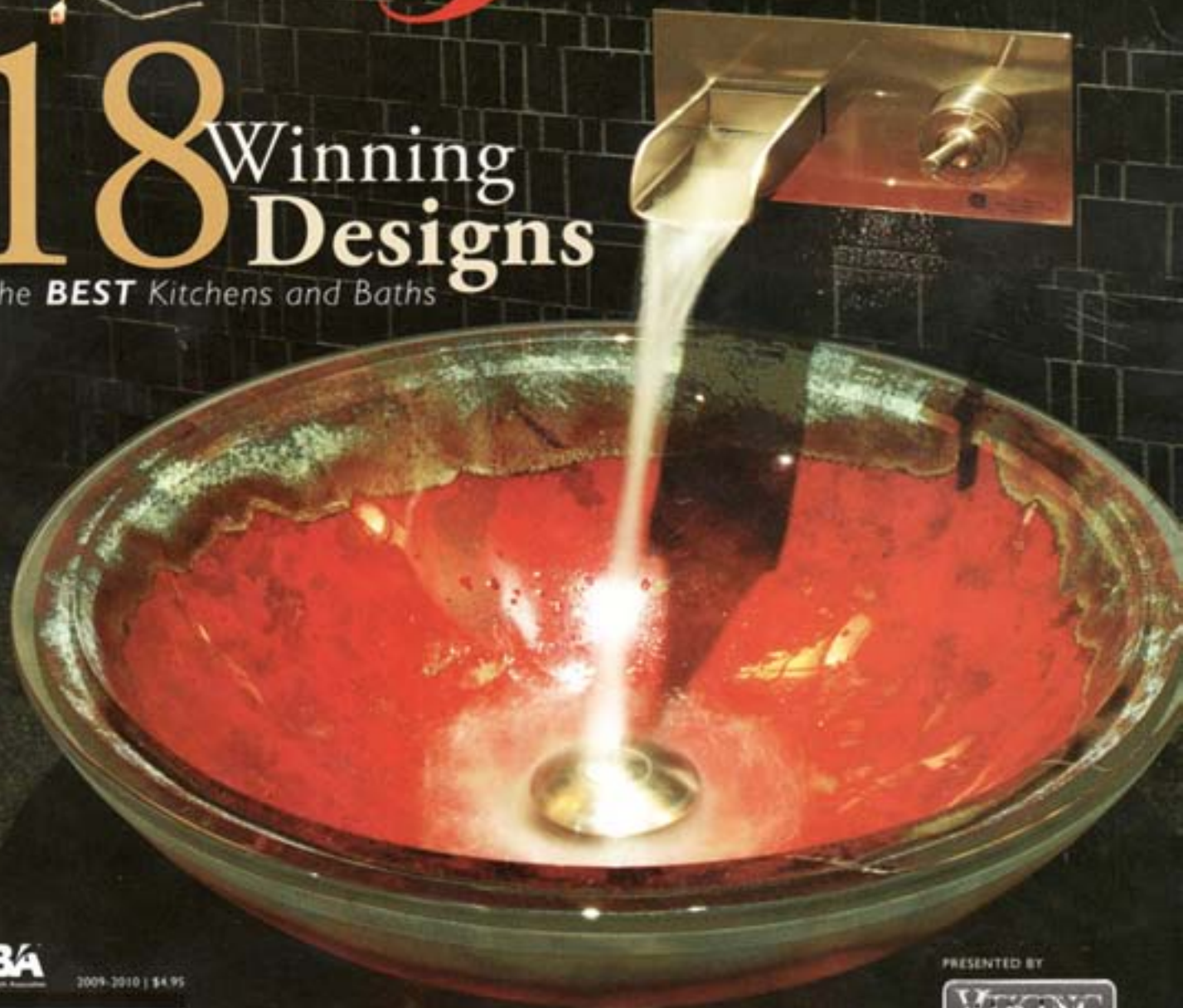

NKBA
National Kitchen & Bath Association

2009-2010 | \$4.95



premiermedia.net

PRESENTED BY

VIKING

150 Hot
Products

10 Improvement Tips
From the Pros

Hardware: Little
Details, Big Impact

1

AWARD: FIRST PLACE
 DESIGNER: SCOTT AND SANDRA GJESDAHL
 FIRM: BRISTOL DESIGN AND CONSTRUCTION



A Star-Worthy Space

The awkward angles of the original architecture of the master suite, plus sloped ceilings and unusual room allocations were all interesting aspects of this home, but these elements did not work well together. The alley-like closet with 13-foot ceilings, adjacent alley-like storage room and master bathroom complete with original 1960s oak and peach tile were completely demolished to create a clean slate. The initial focus was to improve integration and synergy of the good elements, and then polish this diamond in the rough.

With nearly 900 square feet to work with, spaces and circulation became generous and luxurious. A powder room was located closest to the bedroom which allowed remaining bath fixtures — vanities, tub and shower — to be located at the furthest end of the suite where garden views and natural light were best. The ample storage closet opposite the powder room is a catch-all for linens, toiletries and medicines in addition to balancing the floor plan.

The dressing room, fit for a Hollywood star, is complete with a Champagne refrigerator. A make-up vanity for her and the handsome tie storage for him (which hides a secret cabinet) carry out the statement. To access remote storage and embrace the height of the room, a custom-built library ladder was integrated, adding to the grandeur and ambiance. Another stunning feature is the adjustable triptych mirror, supported by columns. It adds to the stage with the custom oversized ottoman taking its center. One wing of the mirror conceals an in-wall ironing board that services the laundry room area of the suite.

Anigre and walnut custom cabinets were specifically designed for his and her storage requirements. These woods were used throughout the suite, complemented with Costa Esmeralda granite, Italian tumbled glass mosaic and marble, and white bronze hardware. Golden carpet and the shimmering bedding and ottoman fabrics, collecting colors from the suite, complete the scene perfectly.



CATEGORY SPONSOR

Organized Spaces

CABINETS: Anigre and walnut, custom by Bristol Design and Construction. **COUNTERTOPS:** Costa Esmeralda. **GRANITE TILE:** Eco Quartz. **EXTERIOR:** glass, oyster beige marble. **PLUMBING FIXTURES:** Kohler Memoirs Suite; Ladena sink; Bari Litra Meridian tub. **APPLIANCES:** Asko washer/dryer. **LIGHTING FIXTURES:** Hendrick; Kichler; Merks Lavery. **FLOORING:** Canalet carpet, oyster beige marble, walnut. **OTHER:** Hardware: Sun Valley bronze.

LIEBHERR Quality, Design and Innovation

The worldwide leader in premium refrigeration brings fresh European design to the American marketplace, providing outstanding built-in, freestanding and fully integrated models. Liebherr's **ActiveGreen** initiative combines Energy Star operating efficiency with greener manufacturing methods and the use of materials that have less impact on our eco systems. Think **Green...** Think Liebherr.



36" French door model & 48" refrigerator/freezer with wine storage are pictured above. The Liebherr collection includes other models ranging in size from 24" to 60" widths.

Distributed by Tri State Distributors
Kent, WA. tristatedistributors.com

Call 800-488-0646 for the name of a
dealer in your area.

IRONS BROTHERS CONSTRUCTION, Inc.

#IRONSBC961LC



Full Service Design/Build



Kitchens – Bathrooms – Additions

www.ironsbce.com 206.306.PROS (7767)

Providing Greater Seattle Clean Professional Remodels Since 1999



AWARD: SECOND PLACE

DESIGNER: SCOTT AND SANDRA GJESDAHL

FIRM: BRISTOL DESIGN AND CONSTRUCTION

2

ENTRY CATEGORY: LARGE BATH



Luxurious and Cozy

This mid-century rambler, in its original state down to the '78 vinyl records and Vegas wallpaper, needed some serious attention. The designers had a wonderful beginning palette available to open up a beautiful master suite that sits on the back structure overlooking waterfalls, koi ponds, in-ground spa and a hot cave.

The goal of the project was to create a dramatic and open spa-like experience while still allowing the spaces to feel cozy and luxurious. The designers accomplished this with the spoon-shaped Victoria and Albert tub floats in the middle of the room with an etched Italian porcelain column and shower as the perfect backdrop. His-and-her vanities, custom cabinetry, and Aspen white granite counters add to the illustrious spa-like feel. A breathtaking system separates the bath from the bedroom — it includes a spinning anigre and afromosia column that houses a flat panel television on one side and a custom shoe rack, jewelry case and tie storage on the other. The column spins with the touch of a finger.

With the blending of natural light, organic shapes, sophisticated woodwork and cabinetry and stunning hard surfaces, the designers managed to create a truly luxurious and cozy space.



CABINETS Custom anigre and afromosia by Bristol Design and Construction
COUNTERTOPS Aspen white granite
TILE Tokolan **PLUMBING FIXTURES** Hans Grohe Metavid, Toto, Victoria and Albert
APPLIANCES Aiko washer and dryer
LIGHTING FIXTURES Tech Lighting
FLOORING Marazzi porcelain **OTHER** Hardware by Sun Valley bronze and Unica

CATEGORY SPONSOR

**Organized
Spaces**

1

AWARD: FIRST PLACE

DESIGNER: SCOTT & SANDRA GJESDAHL

FIRM: BRISTOL DESIGN & CONSTRUCTION



Japanese-Infused Style

This 1960s home had a small, isolated galley-style kitchen that was in need of an update. The Bristol Design and Construction team of Kirkland decided to take a "glass house" approach, creating a kitchen that flowed seamlessly to an outside courtyard, thanks to smart design and large floor-to-ceiling windows.

The classic, contemporary floor plan already there lent itself perfectly to an Asian-influenced remodel, Scott and Sandra Gjesdahl explained. They built custom sliding shoji partitions to the design to control connectivity and circulation of the space, they said. The curved kumiko latticework on the screen adds a welcome, organic element. A similar set of shoji doors are

in the hall used to conceal a coat closet and laundry room, and further unify the space around the courtyard.

The informal dining table is supported by a stainless steel apron that cantilevers from the island to further offer a weightless ambience to the space. The warm, golden undertones of the sapele custom cabinets provide a glow that complements the translucency of the shoji screens. Pebble green concrete counters were chosen for their subdued texture and the Italian porcelain floors go with the courtyard's marble gravel. Local artists made the paper light fixtures that add a soft, tranquil feel to the space. The kitchen is simply elegant that screams, or shall we say, hums, Zen.



CATEGORY SPONSOR

PACIFICCREST
industries

CABINETS Sapele, Wenge and VG Fir, custom made by Bristol **COUNTERTOPS** Concrete by Kalzen Concrete **PLUMBING FIXTURES** Danze Como **APPLIANCES** Liebherr, GE Monogram, Vent-A-Hood with custom surround by Bristol **FLOORING** Bianco Instone **SHOJI DOORS** Custom-made by Bristol **CABINET HARDWARE** Acom Hardware Glass



Decorating on a Dime!

425.466.4483
Paula Kennedy

www.decoratingwithoutrefinancing.com

CHOWN HARDWARE SINCE 1879

www.chown.com

Quality Products at
Every Price Level

Decorative Plumbing
Door Hardware
Cabinet Hardware
Steam/Bathtub
Bathroom Cabinets
Bath Accessories

Washington Showroom
12001 N.E. 12th St. # 38
Bellevue, Washington
800-574-4312

Oregon Showroom
333 N.W. 16th Avenue
Portland, Oregon
800-452-7634



CABINETS Custom, stained white oak with walnut **COUNTERTOPS** Maple, Red granite **TILE** Masterpiece Copper **PLUMBING FIXTURES** Florsheim Copper SINKS and other fixtures by Kohler **APPLIANCES** Wolf ovens and microwave, Sub-Zero 700 series wine cooler, refrigerator drawers and modules, Fisher & Paykel and Neff dishwashers, Thermomix and Vent-A-Hood ventilation **LIGHTING FIXTURES** Rahn Lighting Tech Lighting and Hubbardton Forge **HARDWARE** Roman Hardware Design



2

AWARD: SECOND PLACE
DESIGNER: SCOTT AND SANDRA GJESDAHL
FIRM: BRISTOL DESIGN & CONSTRUCTION

Ranch-Inspired Update

This lakefront home was built by the owners 50 years ago and was in need of a serious update. Designers Scott and Sandra Gjesdahl of Bristol Design & Construction removed walls that separated the kitchen from the other rooms and opened the space up to accommodate entertaining extended family. That also helped maximize the view of the lake.

Appliances were placed with convenience in mind — like placing the two ovens side by side to eliminate the need for bending. A food prep area was created in the island and includes a sink and two Wolf induction and a grill module. A microwave and warming drawer also are within easy reach.

Highlights include a copper apron-front sink, 1½ dishwashers and a slab of burl cedar “cowboy bar” that sits around a giant pole and an informal “wagon wheel” dining table at the end of the central island. The designers describe the look as “authentic ranch ambience, refined.”

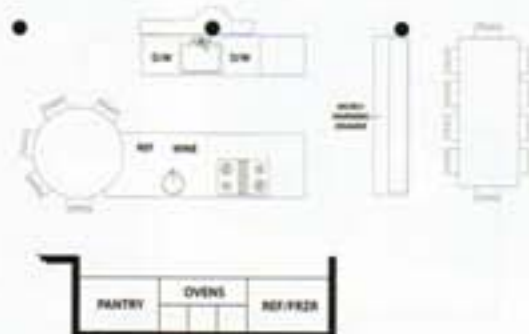

CATEGORY SPONSOR

HomeSavvi



2

AWARD: SECOND PLACE
 DESIGNER: SCOTT AND SANDRA GJESDAHL
 FIRM: BRISTOL DESIGN AND CONSTRUCTION

Built-In Beauty

At first glance, this home's mid-century details (shag carpet, wood-paneled walls and small segregated spaces) were a bit abrasive, but closer inspection showed exemplary architecture, classic lines and great bones. "The clients wanted everything to be seamlessly modern, yet unquestionably 'now' for them regarding function, materials and appliances," said Sandra Gjesdhal of Bristol Design and Construction.

Balance was key for the designers. Elements such as a monumental figured anigre column, quarter-sawn afromosia paired with anigre cabinetry and a cantilevering custom hood bring together the room. The island floats above the floor, supported by a cold-rolled steel bar. Rather than terminate at the column, the island penetrates it, creating the entry table. The column also houses all plumbing and power for the island.

Beautiful Carrera marble integrated into the bartop, large tile backsplash, a caterer's dream pantry and a hidden television in a cold-rolled steel cabinet round out some of the more exciting details of this open kitchen. One of the most stunning elements is the dramatic 11-foot-long sapele wood slab chosen for the dining room table, connecting to the heavily wooded exterior.

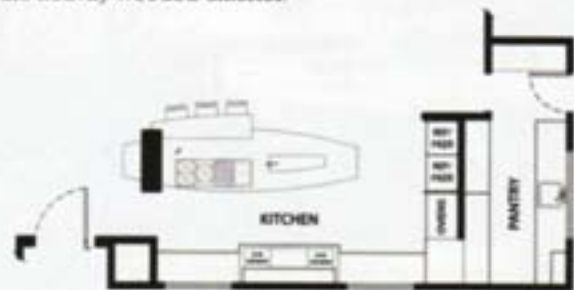

CATEGORY SPONSOR

caesarstone
 Quartz Surfaces



PHOTO BY SANDRA GJESDAHL

CABINETS afromosia and anigre, custom by Bristol
COUNTERTOPS Basaltina slab, Carrera marble **TILE** Carrera
 marble **PLUMBING FIXTURES** Custom sinks, Hans Grohe,
 Ion Ways **APPLIANCES** Sub Zero 700, Wolf ovens, Abbac
 hood liner, washer/dryer, microwave and modules by Fisher
 Paykall, Asko dishwasher, Miele coffee maker **LIGHTING**
 Alfa, Europhase and Kichler **FLOORING** Marazzi Tile **OTHER**
 Hardware by Sun Valley Bronze and Linnea